



**THE DIKMAN  
COMPANY**

Licensed Real Estate Broker

Commercial/Industrial Real Estate Services

**Raising the Bar in Customer Satisfaction**

**7,080 SF Available for Lease - November 30, 2018  
2250 Massaro Boulevard, Tampa, FL 33619**



- Located in Tampa East Industrial Park, just off US Hwy 301
- Close Proximity to SR 60, Lee Roy Selmon, and I-75
- 7,080 MOL, including 1,024 SF office
- 18' - 22' Clear Height
- (2) grade level doors - one oversized at 14x14; (1) exterior dock high ramp
- 3 offices, 2 open to the warehouse; 1 in the warehouse
- 2 bathrooms; men's bathroom opens up to the warehouse
- \$6.95/sf NNN; operating expenses estimated \$2.25/sf
- 3 phase power; 120/208 v; 200 amps



**Erika Z. Matscherz**  
Licensed Real Estate Associate  
Commercial/Industrial Brokerage  
813-251-5288 ext. 102  
813-215-4342 (cell)  
erika@dikman.com

**Sales  
Leasing  
Property Management  
Development  
Tenant Representation  
Investment Counseling  
Asset Analysis**

No warranty or representation, expressed or implied, is made as to the accuracy of the information contained herein, and same is submitted subject to errors, omissions, change of price, rental or other conditions, withdrawal without notice, and to any special conditions by our principals.



**THE DIKMAN  
COMPANY**  
Licensed Real Estate Broker  
Commercial/Industrial Real Estate Services

**Raising the Bar in Customer Satisfaction**

**7,080 SF Available for Lease - November 30, 2018  
2250 Massaro Boulevard, Tampa, FL 33619**

**Great stand alone building in East Tampa with shared fenced in yard for outside storage/parking  
Neighbor to: United Rentals, Loomis, Lighting Bolt & Screw, Mastec, Logan Lumber, Grainger**

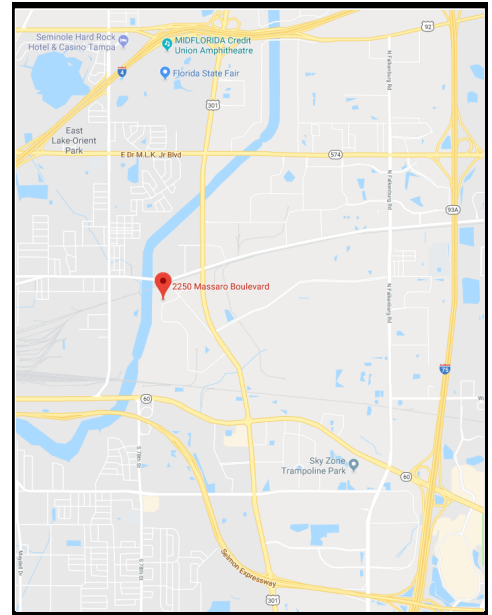
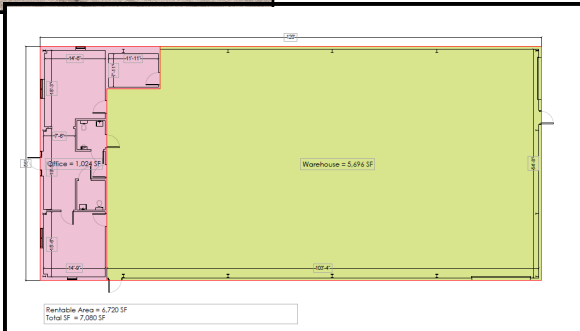

**Erika Z. Matscherz**  
Licensed Real Estate Associate  
Commercial/Industrial Brokerage  
813-251-5288 ext. 102  
813-215-4342 (cell)  
erika@dikman.com

**Sales  
Leasing  
Property Management  
Development  
Tenant Representation  
Investment Counseling  
Asset Analysis**

No warranty or representation, expressed or implied, is made as to the accuracy of the information contained herein, and same is submitted subject to errors, omissions, change of price, rental or other conditions, withdrawal without notice, and to any special conditions by our principals.